

HIGH INTENSITY RARE EARTH DRUM SEPARATOR (HIRE)

DESCRIPTION

Swenco High Intensity Rare Earth Drum Separator efficiently removes very fine micron sized iron contamination from products. It is also used for separation of paramagnetic minerals.

The drum 15" in diameter has a stationary High Intensity Rare Earth magnetic assembly inside a Stainless Steel shell. The ends of the drum have Aluminum flanges. The magnet assembly is mounted on an EN-8 Shaft.

This drum assembly is enclosed inside a Mild Steel housing provided with a two way discharge chute. A stainless steel feed hopper with an adjustable slide gate feeds the product on to the drum surface. When the drum rotates the magnetic particles adhere to the drum surface and is released using a wiper into the magnetic discharge chute. The clean product is discharged by material trajectory into the product chute.

An adjustable Stainless Steel splitter is provided, with an inspection door to view the splitter position.

The drum has a peak intensity in excess of 6500 gauss on the shell surface.

The drum is available in widths starting from 12" up to 48" in increments of 6 inches.

FEATURES

- 15" Diameter Drum
- Stainless Steel Shell
- Mild Steel housing with two way discharge chute
- Stainless Steel feed hopper with adjustable gate
- Peak intensity on Drum surface – 6500 gauss
- The entire unit mounted on a Mild Steel frame
- Geared motor with V-Belt transmission.
- Ready to install



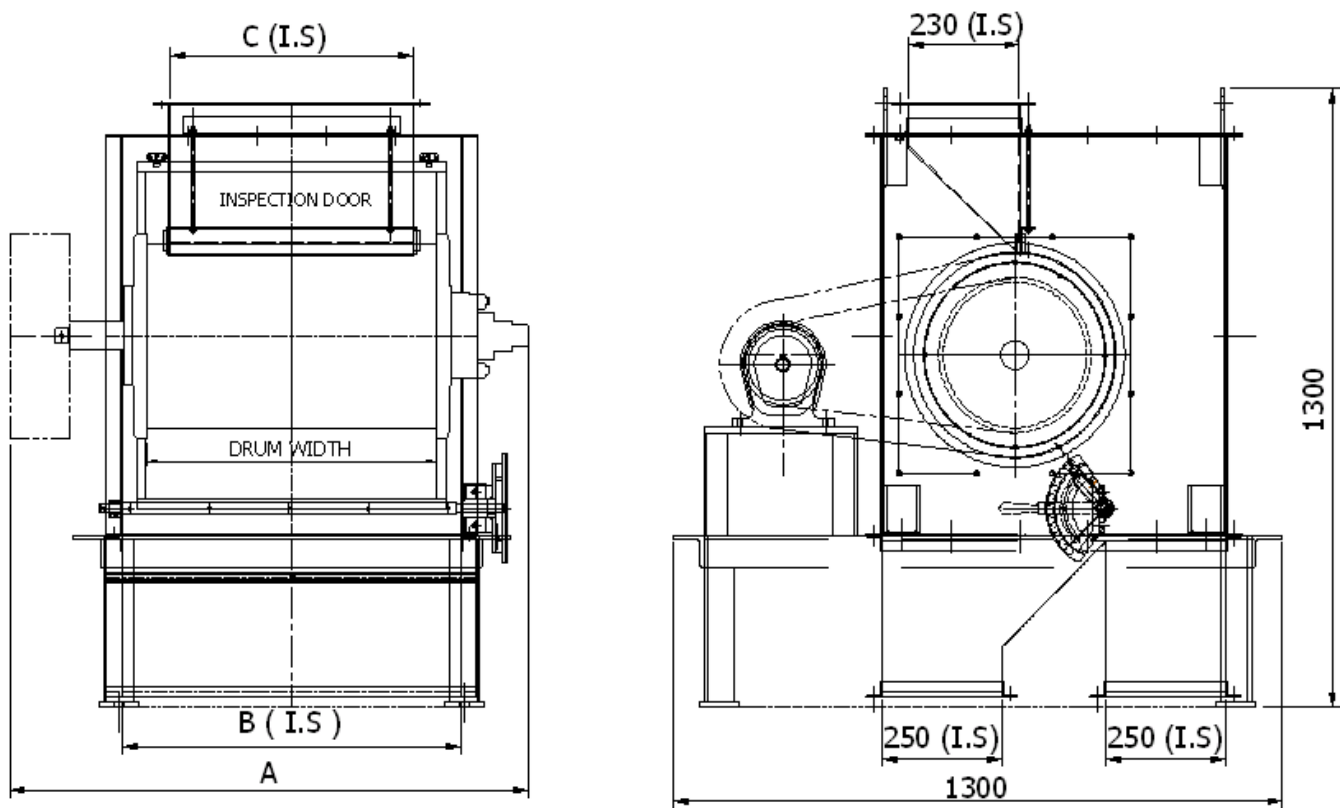

DRUM WIDTH mm (Inches)	A mm	B mm	C mm	MOTOR Kw
305 (12")	800	415	210	0.56
457 (18")	950	565	360	0.56
610 (24")	1100	715	510	0.56
762 (30")	1250	856	660	0.75
914 (36")	1400	1006	810	1.1
1067 (42")	1550	1156	960	2.2
1219 (48")	1700	1306	1110	2.2

*Dimensions and specifications are subject to change without notice

Email: info@swencoind.net